



## INSTALLATION PROCEDURE, Individual

**DO NOT DISCARD**  
**PLEASE READ CAREFULLY BEFORE BEGINNING INSTALLATION.**

Fixtures must be installed by licensed electricians in accordance with all local and national codes. To prevent electrical shock, disconnect electrical supply before installing or servicing.

### Before Beginning Installation, Locate The Following Components. Gather Required Tools.

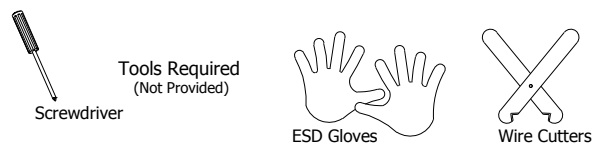

Service Hotline: 1-201-246-8188  
Monday through Friday 9:00AM - 5:00PM

### To Begin Installation: **POWER OFF**

- 1** Mark hole locations on the installation surface matching locations of the mounting hardware. Adjust cables to desired length and cut if needed.

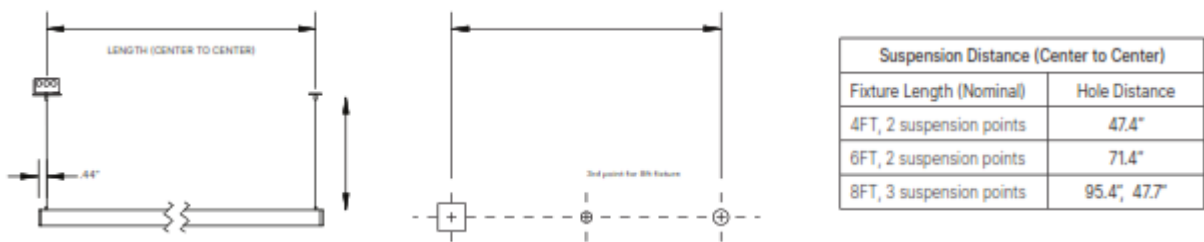

- 2** Locate and install the remote driver. Feed the AC and DC cables to the Junction box. Feed the fixture cables through the Ceiling Gripper/Canopy and connect to the driver box. If your fixture has an Indirect light source, chose the correct driver for each power cord. Secure canopy. Refer to the wiring diagram.

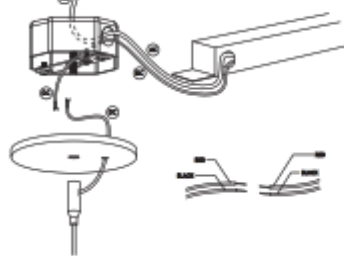

- 3** Fasten the fixture's non-power cable to the mounting surface using hardware rated for your application.

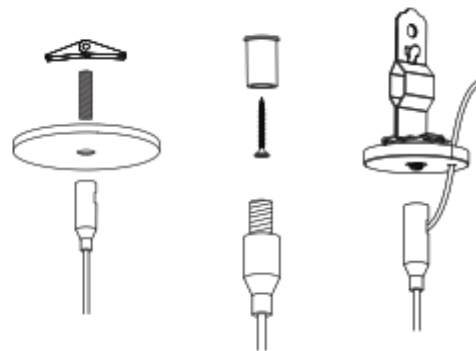

- 4** For 8ft fixtures, snap center suspension bracket into top channel. Screw coupler into ceiling and adjust cable to length.

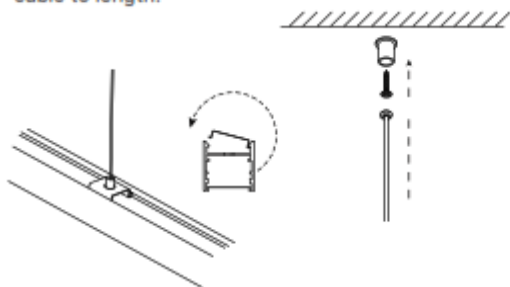

- 5** Final Installation

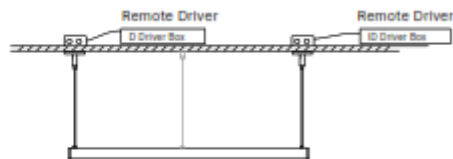

**Care Instructions:**  
Wipe with a soft cloth only. Always avoid using harsh chemicals and/or cleaners.



PICASSO LIGHTING

- 1 Mark hole locations on the installation surface matching locations of the mounting hardware. Adjust cables to desired length and cut if needed. The END OF RUN (EOR) housing has (2) mounting points. This fixture should be installed first for the easiest installation process.



- 2 Raise the "EOR" fixture to the ceiling and secure with the cable kit. The open end of the fixture will be connected to power. Refer to the Wiring Diagram.

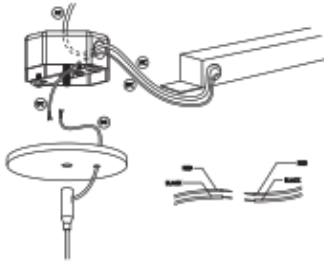

- 3 Fasten the MIDDLE OF RUN (MOR) fixture to the EOR fixture by engaging it into the Joiner Bracket. Lightly engage (1) Set Screw if needed. Secure the Power End of the fixture to the ceiling (Ref Step 2). Tighten the Set Screws in the joiner.

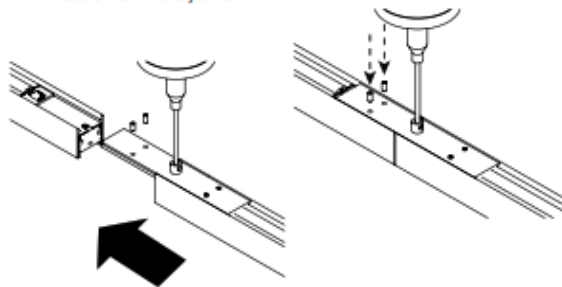

- 4 Repeat previous steps depending on the number of fixtures in your assembly.

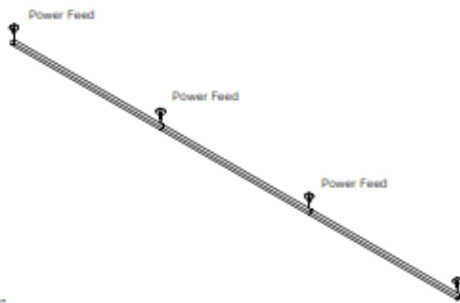

- 5 Install the remote drivers as needed for your specific fixture assembly and installation space. Refer to the Wiring Diagram.

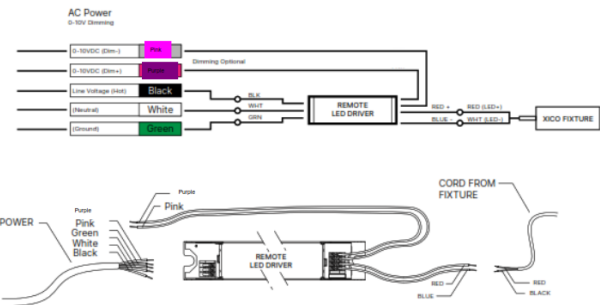

#### Care Instructions:

Wipe with a soft cloth only. Always avoid using harsh chemicals and/or cleaners.

Installation and maintenance of the luminaire may only be performed by qualified and licensed electricians in accordance with all applicable codes and standards. Picasso Lighting Industries, LLC assumes no responsibility or liability for any unauthorized changes or modifications to the luminaire. The luminaire is not intended for outdoor use. Picasso Lighting Industries, LLC. shall assume no responsibility or liability for the integrity of the mounting surface and structure as well as the integrity of all components not provided by Picasso Lighting Industries, LLC. Turn off line voltage and allow luminaire to completely cool before performing any maintenance including routine cleaning of luminaire. Avoid touching LED light emitting surfaces while installing, replacing or providing maintenance to the luminaire. Luminous flux and connected electrical load are subject to an initial tolerance of +/- 10%. Color temperature (k) is subject to a tolerance of +/- 150k from the nominal value. Any component contained in this luminaire can only be replaced by the manufacturer or an agent thereof.

Keep these **INSTALLATION INSTRUCTIONS** in a secure and readily accessible place for any future maintenance or for reference.

**DO NOT DISCARD**  
**PLEASE READ CAREFULLY BEFORE BEGINNING INSTALLATION.**

Service Hotline: 1-201-246-8188  
Monday through Friday 9:00AM - 5:00PM