

CKE series LED, cove fixture, integral drivers.



INSTALLATION PROCEDURE,

DO NOT DISCARD

PLEASE READ CAREFULLY BEFORE BEGINNING INSTALLATION.

Fixtures must be installed by licensed electricians in accordance with all local and national codes.

To prevent electrical shock, disconnect electrical supply before installing or servicing.

Before Beginning Installation, Locate The Following Components. Gather Required Tools.

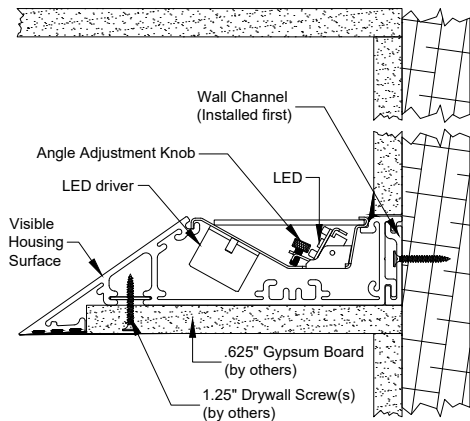

Service Hotline: (201) 246-8188 Monday through Friday 9:00AM - 5:00PM

Tools Required (Not Provided)



ESD Gloves

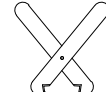

Wire Cutters



Screwdriver

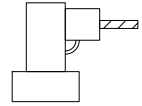

Drill

Components supplied

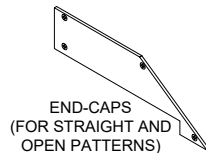

END-CAPS (FOR STRAIGHT AND OPEN PATTERNS)



LED TRAYS



HOUSING



WALL CHANNEL

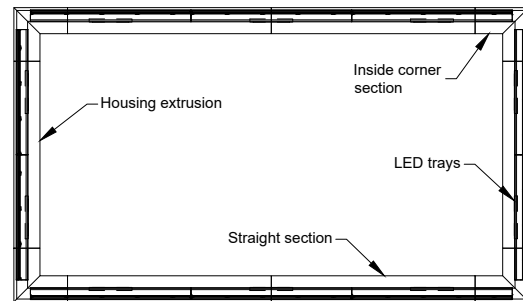
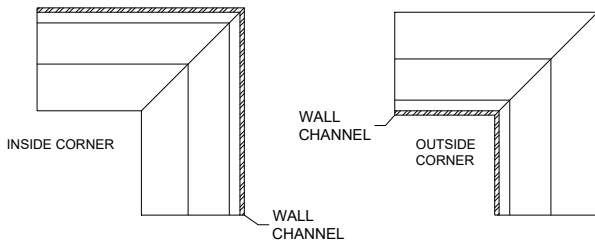

SEE SUBMITTAL DRAWING FOR LAYOUTS/DIMENSIONS.

To Begin Installation:

POWER OFF

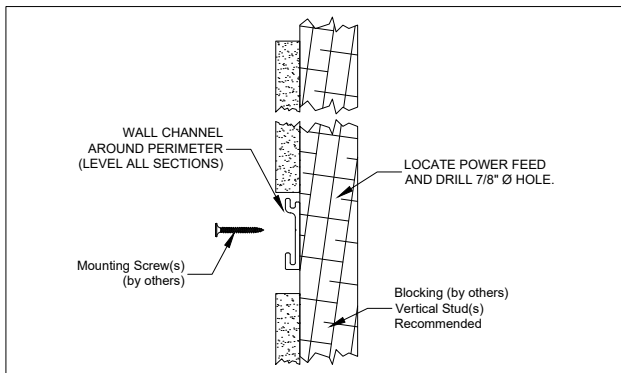

Figure 1. Wall channel installation.

1. Gather all necessary components and start by installing the wall channel around the perimeter with mounting screws (not provided by Picasso Lighting). The channel extrusion must be field cut as required. Locate the power feed and drill a 7/8" Ø hole for greenfield whip. See figure 1 for more details. We recommend installing mounting screws on vertical studs for better support.

2. Once the wall channel is in place, drill a clearance hole in the back of the housing to match the hole on the wall channel for the power feed. Lift and tilt the housing extrusion and install it into the wall channel, see figure 2 for more details. Secure the housing to the wall channel with screws (not provided by Picasso Lighting). Secure the housing in place from the bottom with a screw and install sheet rock hardware previously to spackling and sanding.

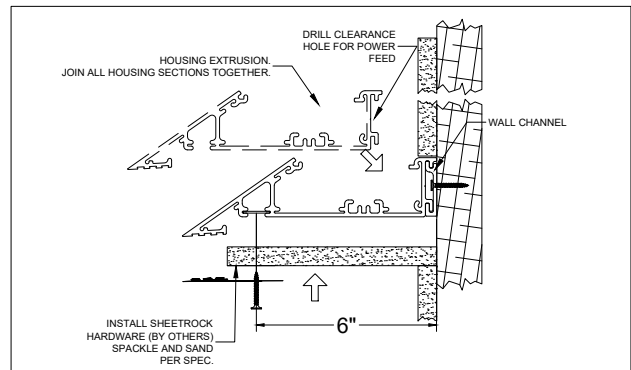

Figure 2. Housing extrusion installation.

CKE series LED, cove fixture, integral drivers.



INSTALLATION PROCEDURE,

DO NOT DISCARD

PLEASE READ CAREFULLY BEFORE BEGINNING INSTALLATION.

Fixtures must be installed by licensed electricians in accordance with all local and national codes.

To prevent electrical shock, disconnect electrical supply before installing or servicing.

Installation (continuation):

POWER OFF

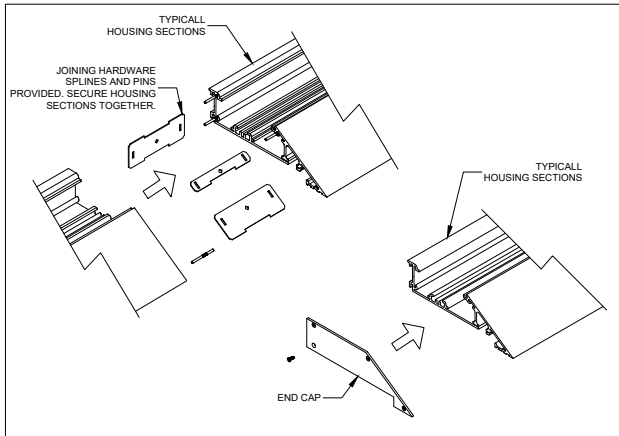

Figure 3. Housing joining hardware & end cap.

3. With one housing section already installed, utilize the provided joining hardware (Pins and Splines) to secure housing sections together. Insert pins and splines and then attach it to the next section. Repeat the process until pattern is complete and secure each one to the wall channel.

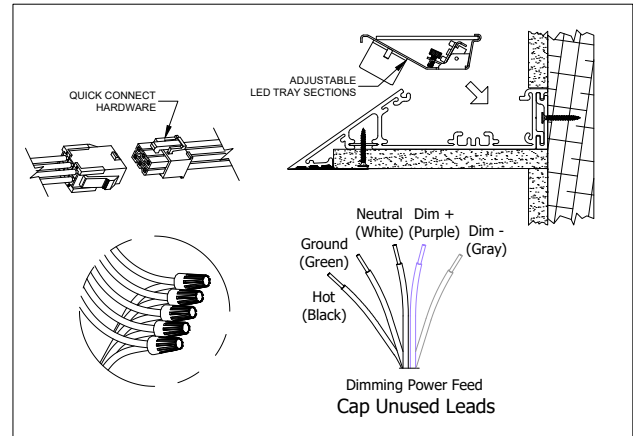

Figure 4. LED trays installation and electrical connections.

4. With all housing sections in place, secured and joined together, install end caps on both ends of the row, see figure 3 for more detail. If you have a closed pattern, end caps are not needed. add a skim coat on the bottom and on the top of the housing where it meets the blocking. The housing sections can be painted to match the ceiling. Finish al painting required before installing the led trays.

Installation (continuation):

POWER ON

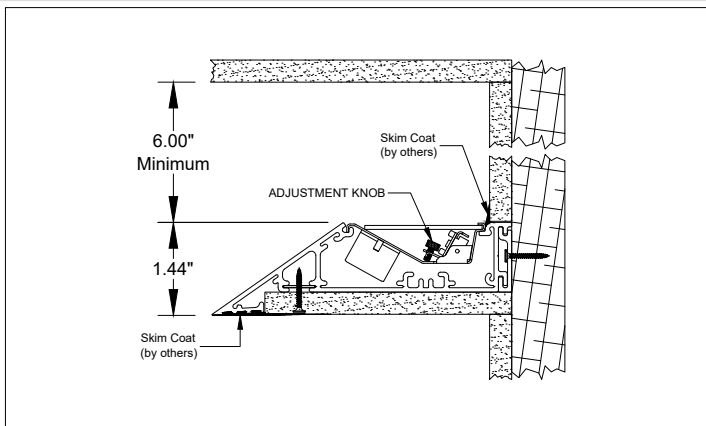

Figure 5. Beam angle adjustment and final installation.

5. install the LED tray sections with lenses into the housing extrusion. Utilize provided quick connect hardware to make the electrical connections, see figure 4 for more details.

Adjust the beam angle as required by removing the lens and using the adjustment knob in the led tray, see figure 5 for more details. Final installation should be at a minimum of 6" from the ceiling to avoid unevenly bright spots.

Installation and maintenance of the **GAITRI** luminaire may only be performed by qualified and licensed electricians in accordance with all applicable codes and standards. Picasso Lighting Industries, LLC assumes no responsibility or liability for any unauthorized changes or modifications to the **GAITRI** luminaire. The **GAITRI** luminaire is not intended for outdoor use. Picasso Lighting Industries, LLC. shall assume no responsibility or liability for the integrity of the mounting surface and structure as well as the integrity of all components not provided by Picasso Lighting Industries, LLC. Turn off line voltage and allow luminaire to completely cool before performing any maintenance including routine cleaning of luminaire. Avoid touching LED light emitting surfaces while installing, replacing or providing maintenance to the luminaire. Luminous flux and connected electrical load are subject to an initial tolerance of +/- 10%. Color temperature (K) is subject to a tolerance of +/- 150K from the nominal value. Any component contained in this luminaire can only be replaced by the manufacturer or an agent thereof.

Keep this **INSTALLATION INSTRUCTIONS** in a secure and readily accessible place for any future maintenance or for reference.

DO NOT DISCARD

Service Hotline: (201) 246-8188
Monday through Friday 9:00AM - 5:00PM